

- building
- clearance required (free of obstructions)
- structural features by others

	dimension	minimum	measured
clear width	B	n.a	..... mm
clear height (1)	H (4)	n.a	..... mm
headroom (3)	A	H + 557 mm	..... mm
shaft height when H < 3350 (3)	AH	2 H + 213 mm	n.a
shaft height when H > 3350 (3)	AH	2 H + 233 mm	n.a
overall depth (2)	F	P + 375 mm	..... mm
clearance (2)	P1	40 mm	n.a
	P2	105 mm	n.a
sideroom pull cord (5)	ZL / ZR	110 / 110 mm	..... mm

- (1) clear height = H + 10 mm (due to weather strip) see detail 2, page "Details"
- (2) in the case of wicket and/or doors with bracing : P1 = 75 mm.
- (3) for headroom (A) of H + 432 mm, the following applies ;

$$H \leq 3350 \text{ mm} : F = P_1 + 375$$

$$H > 3350 \text{ mm} : F = P_1 + 500$$

- (4)  $H_{\text{max}} = 5999$  mm
- (5) for manual chain host and electric drive see page 'sideroom required...'

technical alterations reserved

- Important!**
- the clear opening must be level and square
  - the fitting surfaces must be plumb and in line
  - the finished floor must be laid and level and prevention from water ingress is recommended.
  - the fitting surface should preferably be of steel
  - if unsure of the structural suitability for door installation please contact our Sales Dept.
  - dimensions are indicated in mm



Vertical løft B550

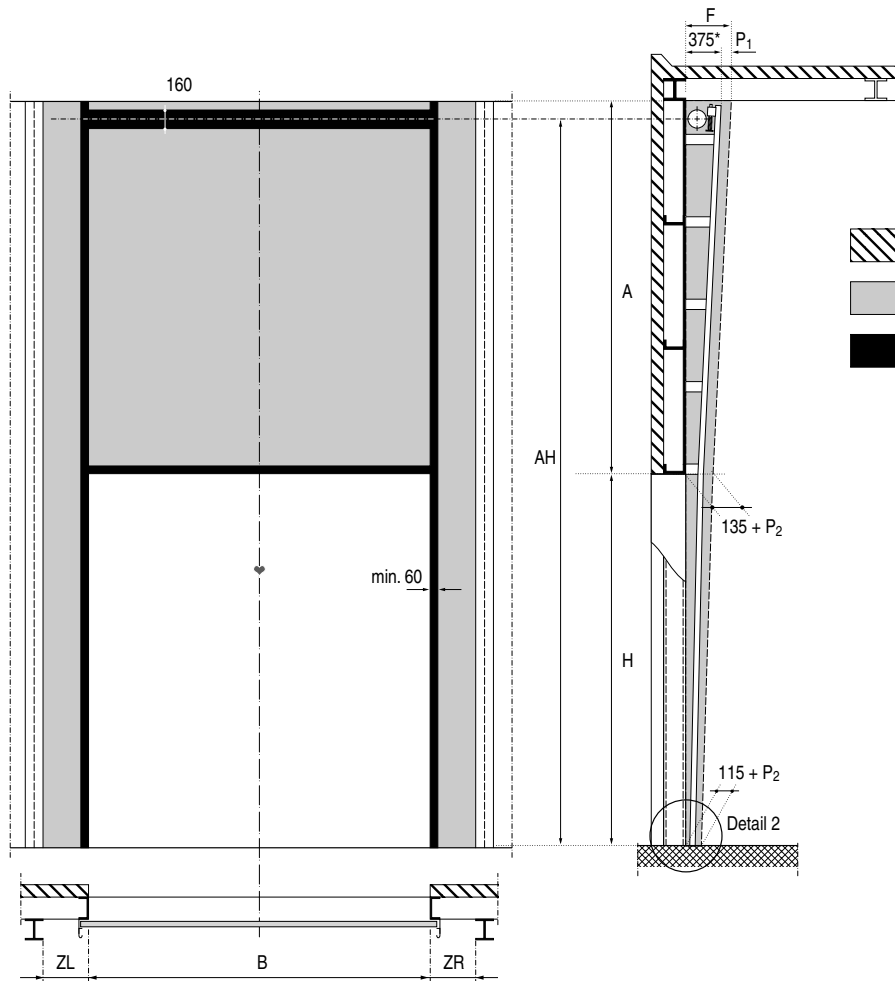

- building
- clearance required (free of obstructions)
- structural features by others

	dimension	minimum	measured
clear width	B	n.a	..... mm
clear height (1)	H (4)	n.a	..... mm
headroom (3)	A	H + 557 mm	..... mm
shaft height when H < 3350 (3)	AH	2 H + 213 mm	n.a
shaft height when H > 3350 (3)	AH	2 H + 233 mm	n.a
overall depth (2)	F	455 mm	..... mm
clearance (2)	P1	75 mm	n.a
	P2	105 mm	n.a
sideroom pull cord (5)	ZL / ZR	110 / 110 mm	..... mm

- (1) clear height = H + 10 mm (due to weather strip) see detail 2, page "Details"
- (2) in the case of wicket and/or doors with bracing : P1 = 75 mm.
- (3) for headroom (A) of H + 425 mm, the following applies ;
  - H ≤ 3350 mm : F = P1 + 375
  - H > 3350 mm : F = P1 + 500
- (4) H<sup>max</sup> = 5999 mm
- (5) for manual chain host and electric drive see page 'sideroom required...'

technical alterations reserved

- Important!**
- the clear opening must be level and square
  - the fitting surfaces must be plumb and in line
  - the finished floor must be laid and level and prevention from water ingress is recommended.
  - the fitting surface should preferably be of steel
  - if unsure of the structural suitability for door installation please contact our Sales Dept.
  - dimensions are indicated in mm



B550 med personaldør